



HOWARD STEIN HUDSON
 114 Turnpike Road, Suite 2C
 Chelmsford, MA 01824
 www.hshassoc.com

PREPARED FOR:
 FRH REALTY LLC
 c/o FAIRFIELD RESIDENTIAL
 5 BURLINGTON WOODS, SUITE 203
 BURLINGTON, MA 01803

**PROPOSED MULTIFAMILY
 DEVELOPMENT
 SUMMER STREET
 WALPOLE, MA**

REVISIONS:

NO	BY	DATE	DESCRIPTION

SITE PLAN

**GRADING AND
 DRAINAGE PLAN
 1 OF 5**

DATE: JUNE 20, 2023
 PROJECT NUMBER: 19097
 DESIGNED BY: PB/KE/KF
 DRAWN BY: PB/MB/KF/KL
 CHECKED BY: KE
 C.19

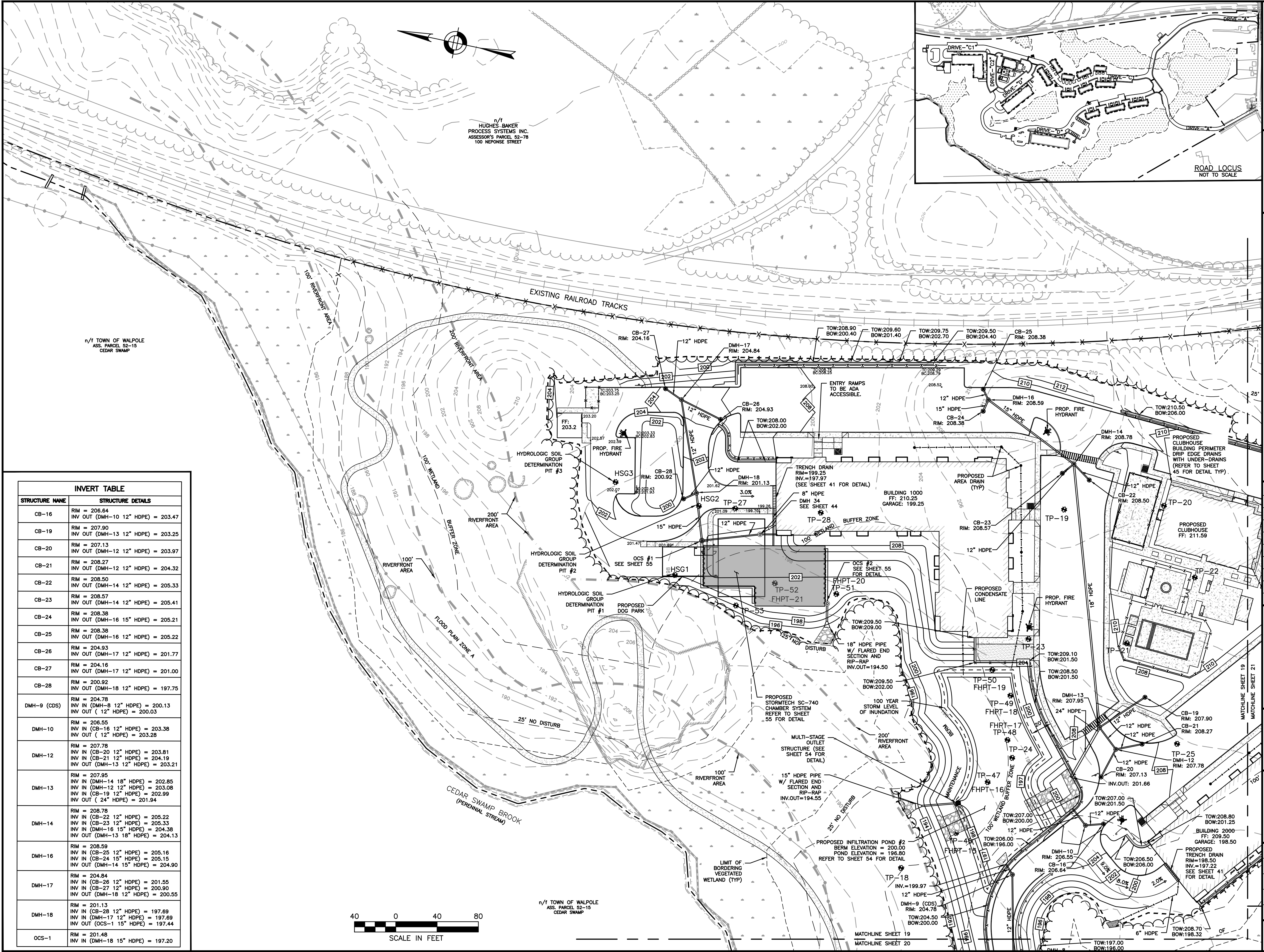

INVERT TABLE

STRUCTURE NAME	STRUCTURE DETAILS
CB-16	RIM = 206.64 INV OUT (DMH-10 12" HDPE) = 203.47
CB-19	RIM = 207.90 INV OUT (DMH-13 12" HDPE) = 203.25
CB-20	RIM = 207.13 INV OUT (DMH-12 12" HDPE) = 203.97
CB-21	RIM = 208.27 INV OUT (DMH-12 12" HDPE) = 204.32
CB-22	RIM = 208.50 INV OUT (DMH-14 12" HDPE) = 205.33
CB-23	RIM = 208.57 INV OUT (DMH-14 12" HDPE) = 205.41
CB-24	RIM = 208.38 INV OUT (DMH-16 15" HDPE) = 205.21
CB-25	RIM = 208.38 INV OUT (DMH-16 12" HDPE) = 205.22
CB-26	RIM = 204.93 INV OUT (DMH-17 12" HDPE) = 201.77
CB-27	RIM = 204.16 INV OUT (DMH-17 12" HDPE) = 201.00
CB-28	RIM = 200.92 INV OUT (DMH-18 12" HDPE) = 197.75
DMH-9 (CDS)	RIM = 204.78 INV IN (DMH-8 12" HDPE) = 200.13 INV OUT (12" HDPE) = 200.03
DMH-10	RIM = 206.55 INV IN (CB-16 12" HDPE) = 203.38 INV OUT (12" HDPE) = 203.28
DMH-12	RIM = 207.78 INV IN (CB-20 12" HDPE) = 203.81 INV IN (CB-21 12" HDPE) = 204.19 INV OUT (DMH-13 12" HDPE) = 203.21
DMH-13	RIM = 207.95 INV IN (DMH-14 18" HDPE) = 202.85 INV IN (DMH-12 12" HDPE) = 203.08 INV IN (CB-19 12" HDPE) = 202.99 INV OUT (24" HDPE) = 201.94
DMH-14	RIM = 208.78 INV IN (CB-22 12" HDPE) = 205.22 INV IN (CB-23 12" HDPE) = 205.33 INV IN (DMH-16 15" HDPE) = 204.38 INV OUT (DMH-13 18" HDPE) = 204.13
DMH-16	RIM = 208.59 INV IN (CB-25 12" HDPE) = 205.16 INV IN (CB-24 15" HDPE) = 205.15 INV OUT (DMH-14 15" HDPE) = 204.90
DMH-17	RIM = 204.84 INV IN (CB-26 12" HDPE) = 201.55 INV IN (CB-27 12" HDPE) = 200.90 INV OUT (DMH-18 12" HDPE) = 200.55
DMH-18	RIM = 201.13 INV IN (CB-28 12" HDPE) = 197.69 INV IN (DMH-17 12" HDPE) = 197.69 INV OUT (OCS-1 15" HDPE) = 197.44
OCS-1	RIM = 201.48 INV IN (DMH-18 15" HDPE) = 197.20

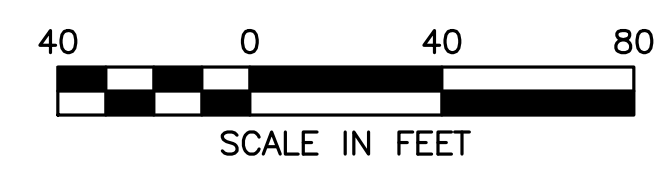

7/11/2023 L:\19097\19097_04 - Lot 2\CURRENT\19097 - Grading Plan.dwg
Matthew Baker