

# REFERENCE

Early Maps  
of  
Walpole, Massachusetts  
1966

Compiled for the Walpole Historical  
Society

1966

By Frank R. Linnah

# REFERENCE

## Index to Walpole Maps

|   | Page |
|---|------|
| 1-Ancient Dedham Grant of 1636                        | 1    |
| 2-Indian Reservation sold in 1685 (East Walpole)      | 2    |
| 3-History of land covered by Indian deed              | 3    |
| 4-Isaac Newton Lewis points out boundary of deed      | 4    |
| 5-The Butcher Map 1696/7 described                    | 5    |
| 6-List of original owners of lots on Butcher map      | 7    |
| 7-Map of part of the Butcher map of 1696/7            | 8    |
| 8-Map showing site of Deacon E.Fales' house ca.1700's | 9    |
| 9-Map of Walpole (Hales' Survey, Day Col.) 1820       | 10   |
| 10-Enlarged detail map of Walpole 1858                | 11   |
| 11-Map of Walpole 1858 (Day Col.Norfolk Co. wall-map) | 12   |
| 12-Map of Plimptonville & East Walpole 1858           | 13   |
| 13-Map of South Walpole - 1858                        | 14   |
| 114-North St.-1733--history of North st.              | 15   |
| 15-Map of North Street, North Walpole - 1851          | 18   |
| 16-The Walpole Town Forest, map                       | 19   |
| 17-Map of the Neponset River                          | 20   |
| 18-Map of South Dedham (now Norwood & part of E.W.)   | 21   |

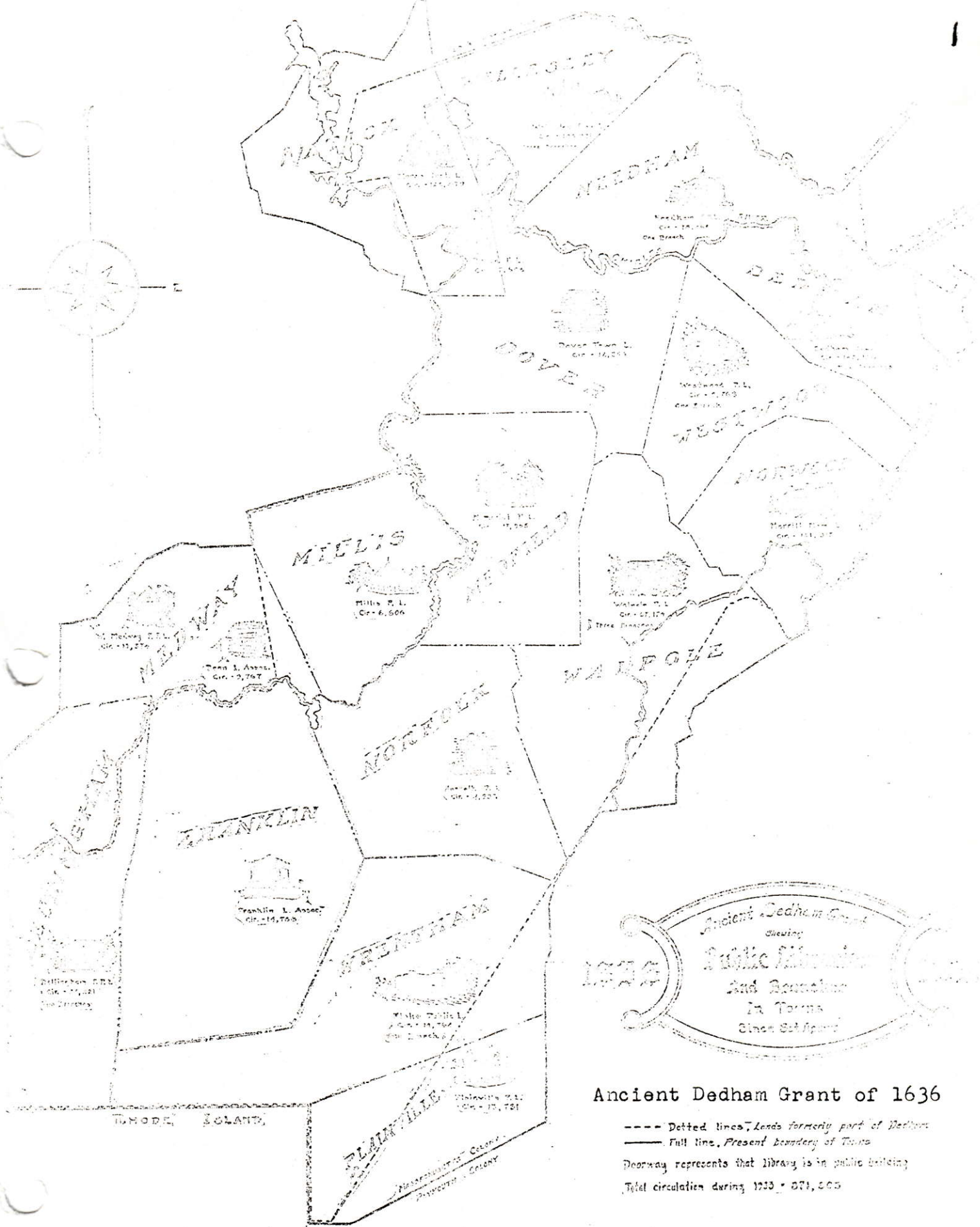

PREPARED BY THE TRUSTEES  
OF THE  
DEDHAM PUBLIC LIBRARY  
ON THE OCCASION OF  
DEDHAM TERCENTENARY

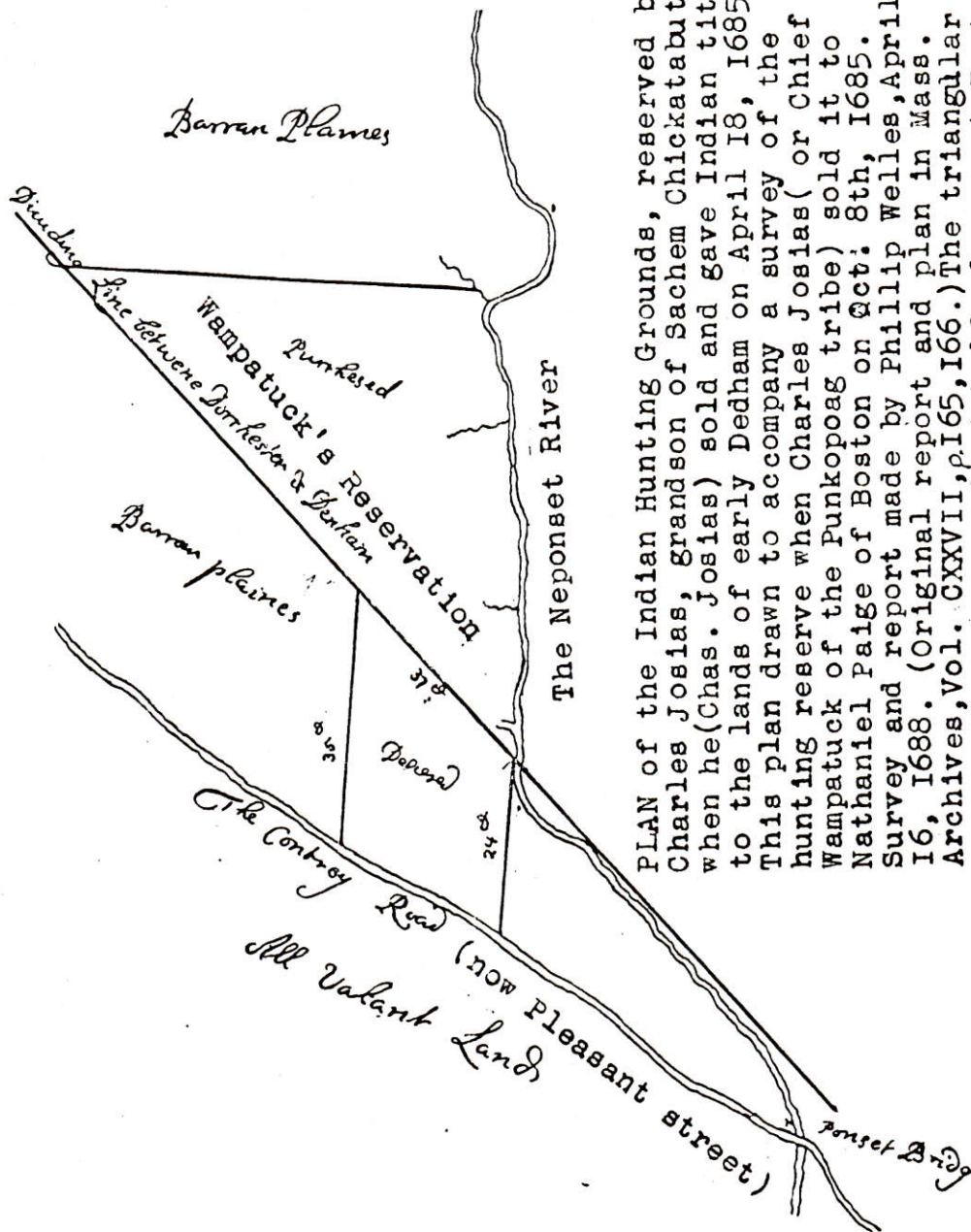

PLAN of the Indian Hunting Grounds, reserved by Charles Josias, grandson of Sachem Chickatabut, when he (Chas. Josias) sold and gave Indian title to the lands of early Dedham on April 18, 1685. This plan drawn to accompany a survey of the hunting reserve when Charles Josias (or Chief Wampatuck of the Punkopoag tribe) sold it to Nathaniel Paige of Boston on Oct. 8th, 1685. Survey and report made by Phillip Welles, April 16, 1688. (Original report and plan in Mass. Archives, Vol. CXXVII, p. 165, 166.) The triangular reservation covers about half of present East Walpole. --WWE, Dec. 1936--

S — N

1685

(later called  
"King's Bridge")

Laid Down by Spralle  
of twenty plaine to an inch

The triangle Land Laid out by Dedham men  
the along Dedham being variant to the Road  
by Nath Page:

7ML



On April 18, 1685 Charles Josias alias Wampatuck gave a confirmatory deed to the town of Dedham reserving Two Hundred Acres of Land in the elbow between Dorchester Line and Neponset River next the said Line near Goodman Vales and other Inhabitants near the Saw Mill of Dedham to be surveyed and laid out by the Inhabitants thereof; also that myself and ye Puncapogg Indians shall have full and free Liberty of Hunting according to Law within the precincts of Dedham.

Charles Josiah alias Wampatuck was the ~~son~~ of Chickatabut.  
grandson

-----  
I have surveyed and laid out for Nathaniel Page a certain tract of land being situated and lying to the south west of Neponset Bridge within the limits of the town of Dedham in the County of ( ) begining at a markt tree standing on the south side Neponset River where the dividing line between Dedham and Dorchester crosses the said River and runs by said line by a range of marked trees and stakes south-west one degree southerly ninety-two chains and then turns north sixty-two chains to Neponset River and so by said river as it runs easterly to the marked tree where first begun, at. In form triangular and is bounded south and west by common land not laid out and northerly by Neponset River, containing within said bounds two hundred acres. Phillip Welles, surveyor April 16, 1688.

-----  
Also another tract of land lying to the south-east of Neponset Bridge joining to the former within the limits of Dorchester bounds, beginning at the north-east corner of the former tract at the tree standing by Neponset River and ranging by the dividing line between Dorchester and Dedham south-west one degree southerly thirty-three chains and

Indian Deed of Dedham

then in length on the south side east thirty-five chains to the Country Road and then in breadth by the County Road north twenty-five degrees Easterly twenty-six chains and then in Length West twenty-four chains (to the) tree where first began being bounded north-east and south-west by the Commons not laid out East by the Country Road and North-west by the former land, containing seventy acres being in all two hundred and seventy acres.

Performed this 16 day of April 1688

Phillip Welles, surveyor

(copied from the Dedham Historical Register" for April 1898, pages 42/45

Isaac Newton Lewis, the historian, lived in the white house in back of the little Lewis Park where the equestrian statue of his ancestor, Lieut. Barachiah Lewis was erected. He was born and died in this house. He told my father in 1926 that looking out his side door, the stone-wall opposite, on the south, bounding the Lewis farm, was the south boundary of the old Indian reservation. Indian arrow-heads have been found around his place. The hill in back called "the pinicle" was the spot where Charles Josias, son of Josias who was a son of Chief Chickatabut, had his wigwam. A valley ~~further~~ ~~along~~ near there was where they planted their corn. A little further along in Plimptonville, near the Neponset River, is still to be seen an old Indian mortar in a ledge in the grass. In his Lewis family History he says that his land was the extreme westerly border of the old Indian reservation.

F.R.L.

The Butcher Map 1696-1697

A Map & Plat or Draught of the Twelve Divisions of Land as they were Laid out, Bounded and Measured to ye Proprietors in Dorchester -- New Grant beyond ye Blue Hills in ye year of our Lord 1696 & 1697. By order of ye Committee impowered by ye Proprietors for that work.

By me John Butcher, Surveyor

A copy Extracted from the Original by order of ye Proprietors above said and ye vacancies between ye Twelve Division Lots commonly called Waste Land (which has since been laid out and sold, filled up ) Finished Anno Domini 1726 -----

By me James Blake, Jr. Surveyor

(Copied by Frederick Endicott, February 1891)

(Copied by Frederick M. Larrabee, January 1904)

see next page



# The Butcher Map

List of Owners of Lots on Plan 1696 to 1725

School Farm-300 acres  
Leased to Henry White

Lot south of Rob. Sanders  
sold to Col. Brown  
180-acres

Part of no 17 -25-acres  
Sam. Tolman

Lot south of the

School Farm  
sold to Sam. Bullard Jr.

Lot no. 15 240-acres

Will. Sumner

John Bullard

Increase Sumner

Josiah White

Jeffery A. Turner

Simon Pitta

Lot no 8 and part of no. 24

262½ acres

Hewins and Haines (or Homes?)

Lot no. 8 522-acres

Geo. Dier

Will. Pond

Will. Triscot

Clement Maxfield

Ezra Clap

Lot no. 26 -  
Thom. Maudsley

Lot south of Lot. 15  
Mr. Bird, 47-acres

Lot no. 17 - 72-acres

Mr. Potter

Lot no. 16 341-acres  
Stephen Minot

Lot no. 18 97-acres

Price and Tilley

Widow George

Widow Pelton

John Wales

Henry Way

Enoch Wiswell

Lot no. 14 43-acres  
John Fenno, for Twichel

Lot no. 13 143-acres

Thomas Tilestone

Tim. Tilestone

Tim. Foster

Lot no. 10 254-acres  
Thos. Tolman, Sr.  
Thos. Tolman, Jr.  
Geo. Lyon  
Henry Leadbetter  
John Tolman

Lot no. 5 35-acres  
Sam. Pelton

Lot south of no. 5

John Hill

16-0-20

Lot north of no. 13  
sold to Abiel Bird  
30-acres

Lot south of John Hill  
was common land  
sold to Smith & Morse

Lot no. 19 55-acres

Mr. Pool

Part of Lot 49, 37½ A.  
Rob. Sanders

Lot no. 20 18-acres

James Foster

Lot no. 27 81-acres  
Sam. Sumner

Lot no. 21 33½ acres  
Nicholas Bolton

-----



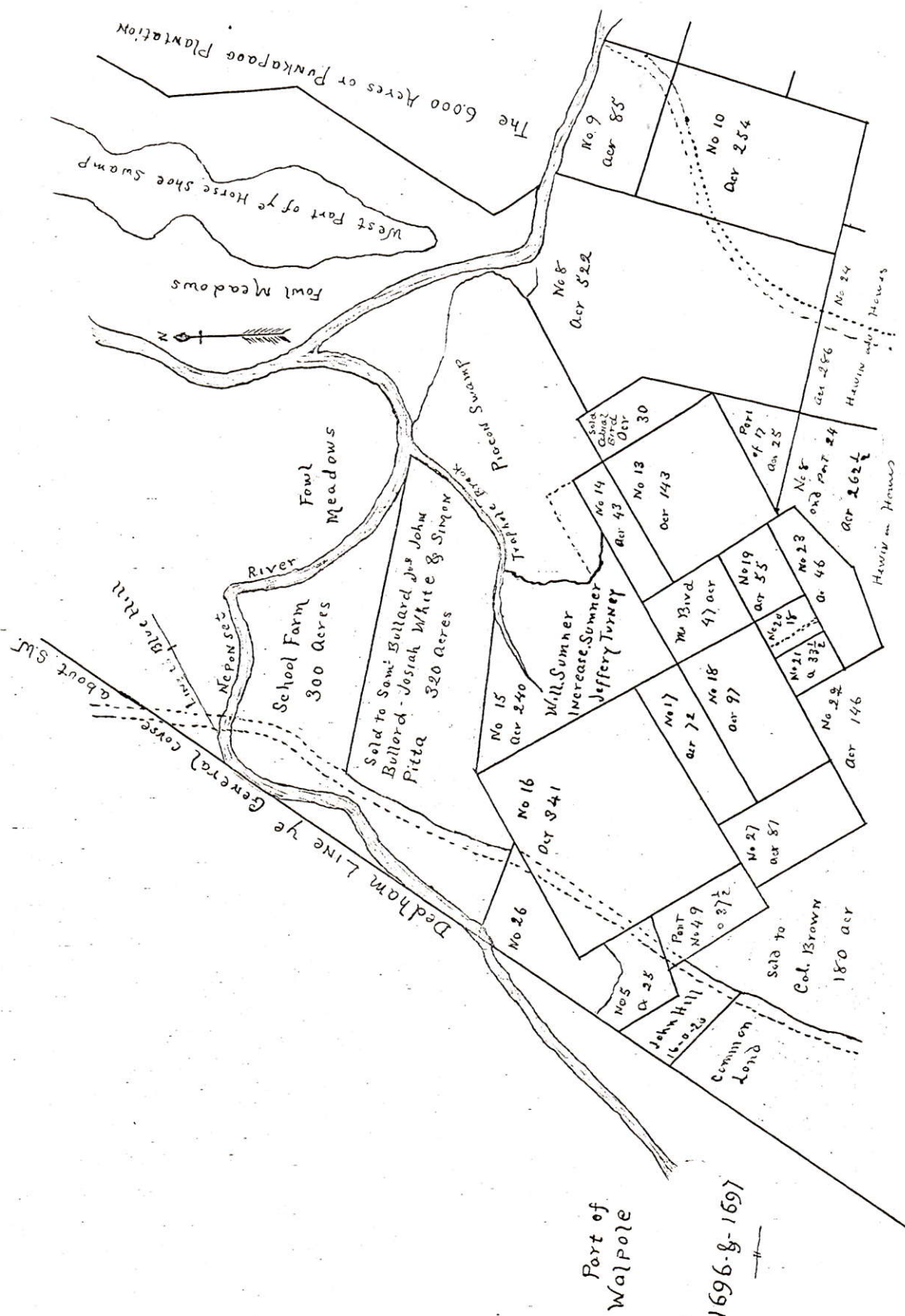

Part of the Butcher Map of 1696/7

1696-8-1691



FRL.

Deacon-Ebenezer Fales House  
Burned down-1922

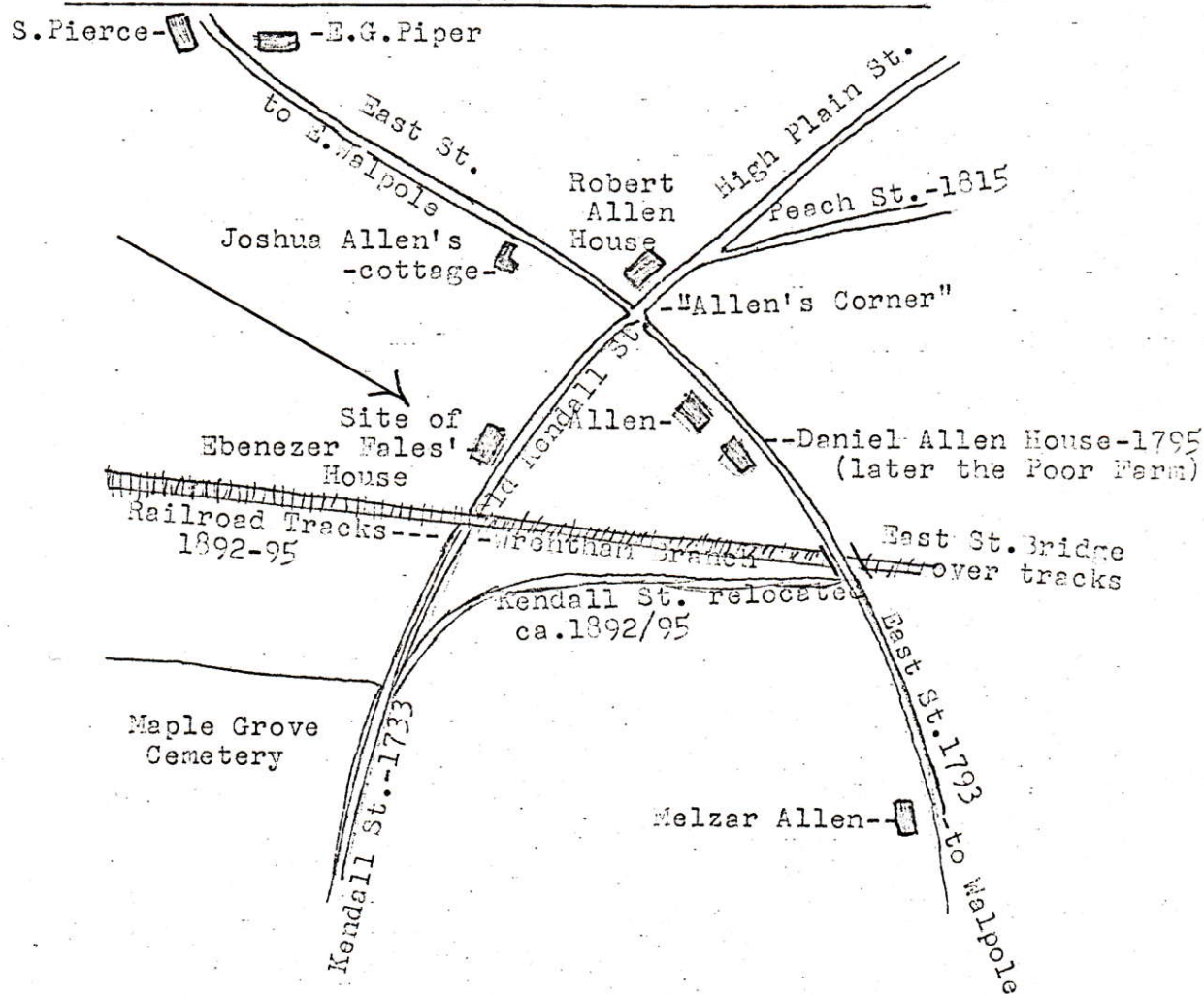

Map showing the site of the Deacon Ebenezer Fales house.  
He was one of the earliest Deacons of the First Church of  
Walpole, Mass.

FRL.

*Frank R. Lanabee*

XERO COPY

XERO COPY

XERO COPY

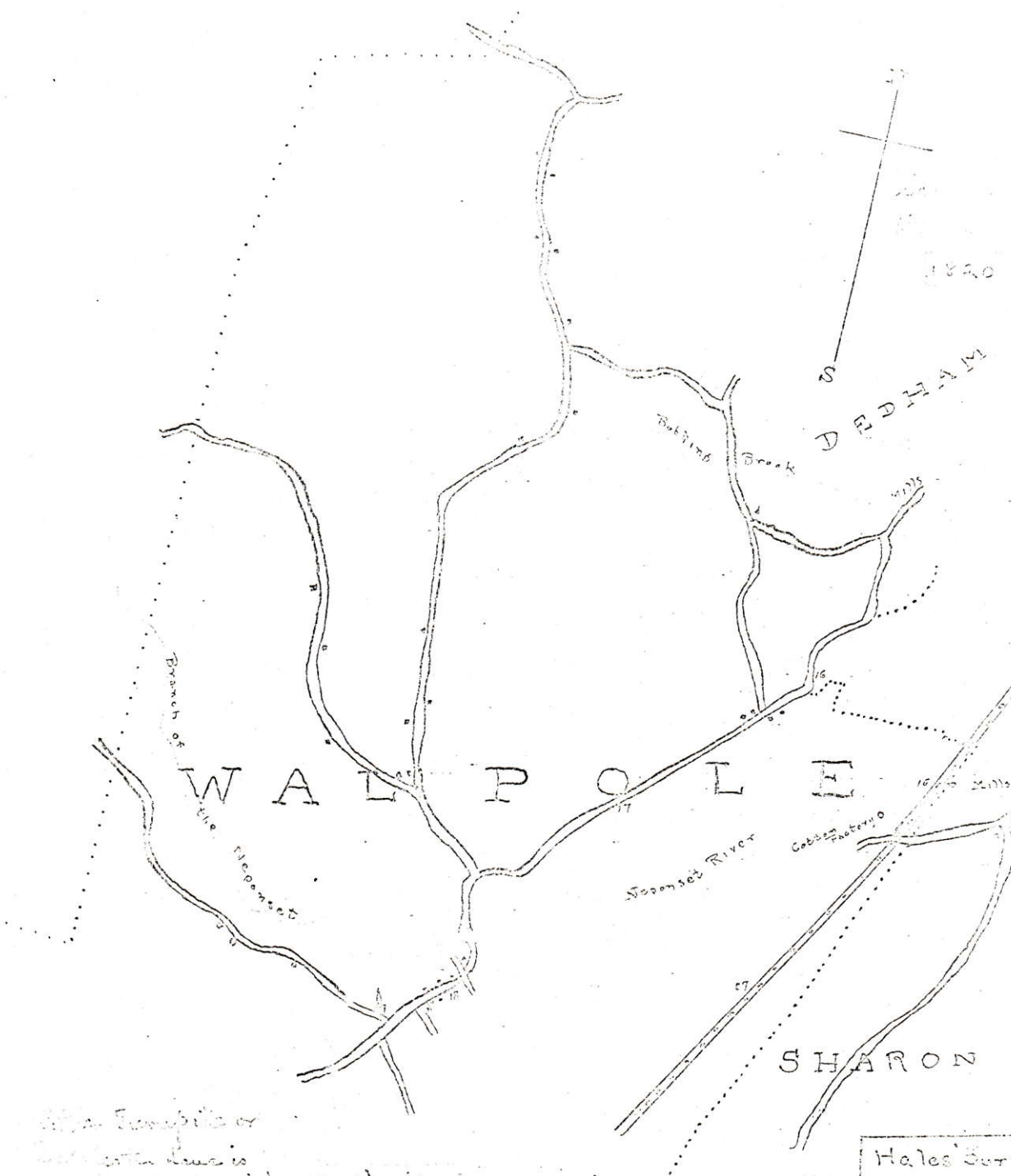

Other description of  
the town is  
very old and is  
not very far from the town.

Hales Survey  
Day Col.

- 1820 -

from the Fred Holland Day  
collection

JAL



KEY TO BUILDINGS

1. T. WHITE
2. J. BOYDEN
3. O. PAGE
4. T. BISHOP
5. H. BOYDEN
6. " "
7. BACON
8. W. GUNNISON
9. A. WASHBURN
10. N. HALL
11. GUNNISON
12. J. HALL
13. T. LOWE
14. H. M. BOYDEN
15. H. BILLINGS
16. C. GUILD 2nd
17. C. GUILD
18. C. MANN
19. E. BAKER
20. " "
21. L. ALLEN
22. L. E. BRUMMETT
23. N. G. PAGE
24. J. ALLEN
25. O. D. YOUNG

Day Col.  
Norfolk Co.  
Wall Map

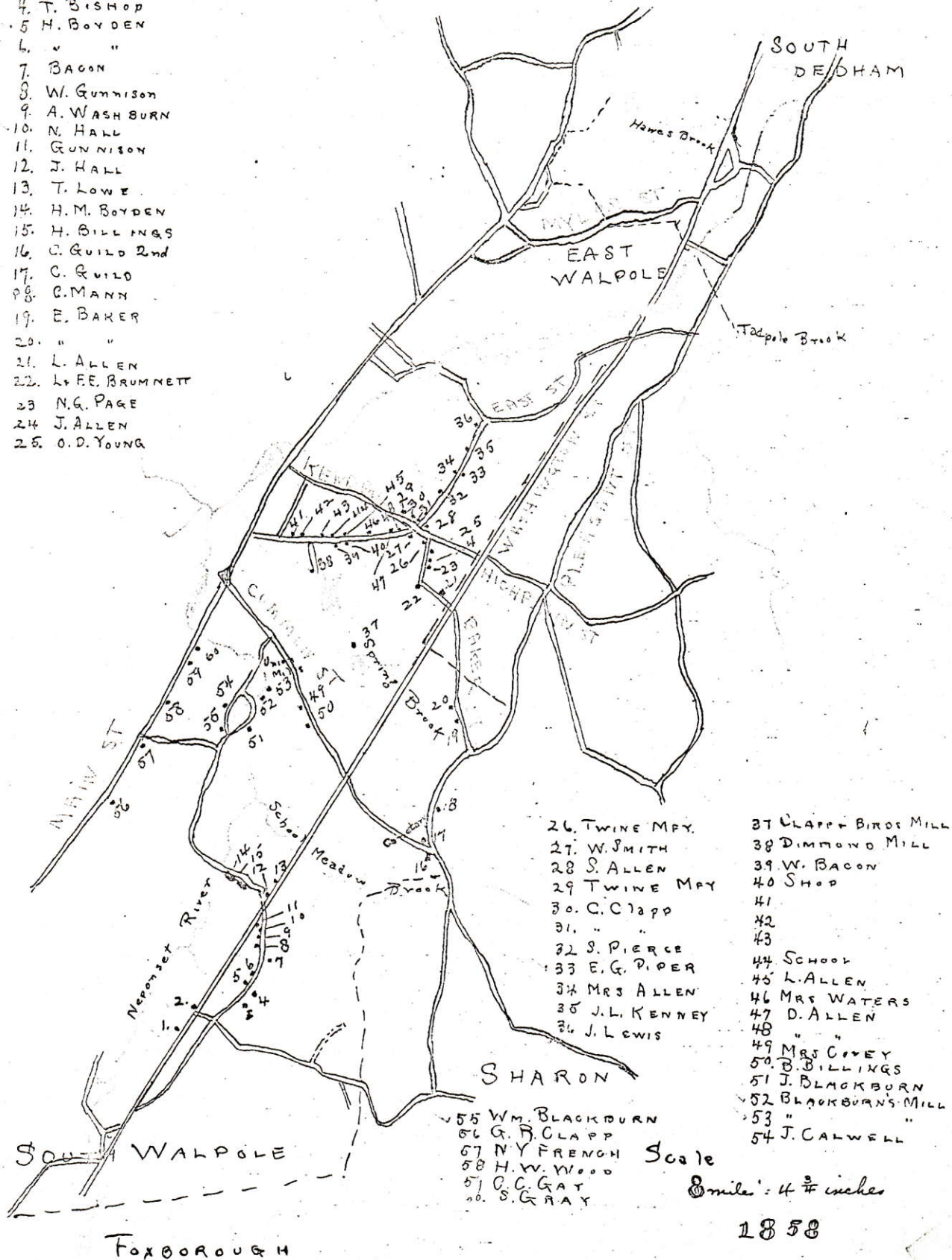

26. TWINE MAP
27. W. SMITH
28. S. ALLEN
29. TWINE MAP
30. C. CLAPP
31. " "
32. S. PIERCE
33. E. G. PIER
34. MRS ALLEN
35. J. L. KENNEY
36. J. LEWIS

37. CLAPP & BIRD'S MILL
38. DIMMOND MILL
39. W. BACON
40. SHOP
41. " "
42. " "
43. " "
44. SCHOOL
45. L. ALLEN
46. MRS WATERS
47. D. ALLEN
48. " "
49. MRS CREEY
50. B. BILLINGS
51. J. BLACKBURN
52. BLACKBURN'S MILL
53. " "
54. J. CALWELL

55. WM. BLACKBURN
56. G. P. CLAPP
57. N. Y. FRENCH
58. H. W. WOOD
59. O. C. GAY
60. S. GRAY

Scale

1/4 mile = 4 7/8 inches

1858

FOXBOROUGH

F. H. Day  
collection

XERO COPY

XERO COPY

XERO COPY

XERO COPY

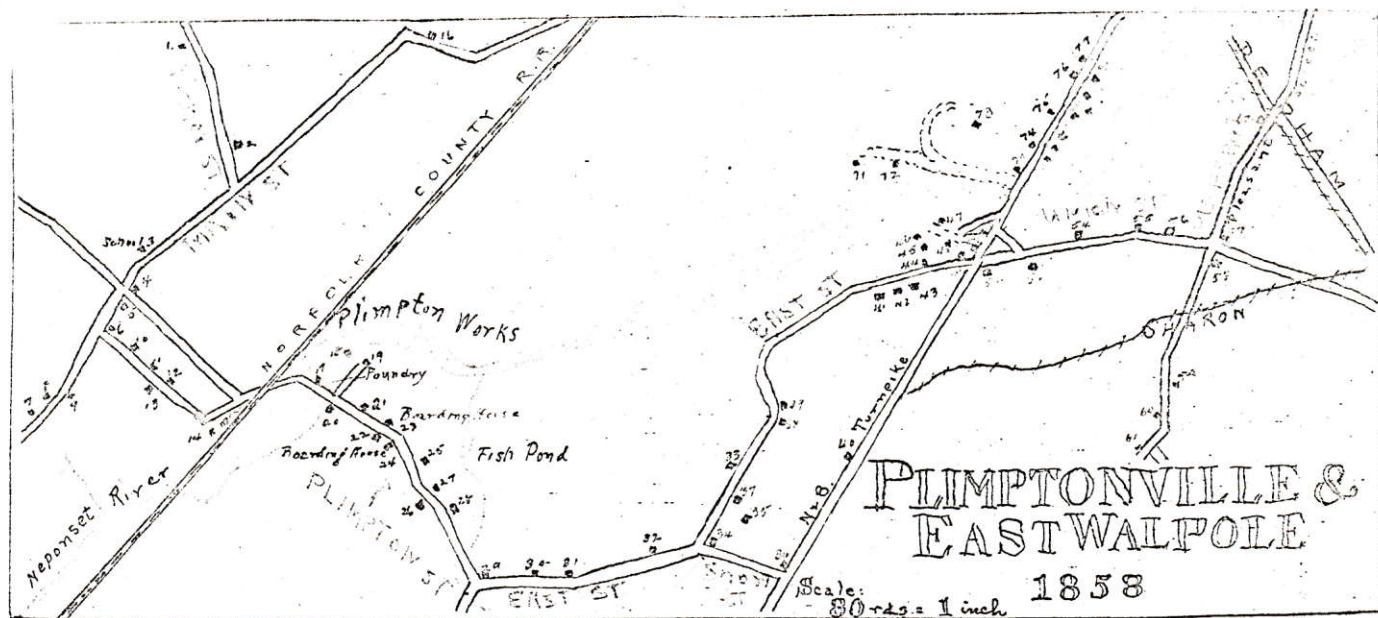

|                   |                    |                    |                       |                                |                                  |
|-------------------|--------------------|--------------------|-----------------------|--------------------------------|----------------------------------|
| 1. H. Day         | 15. A. Clapp       | 25. C. G. Plimpton | 37. School            | 49. Counting Room              | 61. S. G. Fuller                 |
| 2. School         | 16. C. Hartshorne  | 26. " "            | 38. Shop              | 50. A. W. Johnson, Stone & Co. | 62. Mrs. Fales                   |
| 3. Gay            | 17. Depot          | 27. C. S. Root     | 39. B. Pottle         | 51. A. B. L.                   | 63. J. S. Wallace                |
| 4. A. Page        | 18. R. Willett, Jr | 28. Fish           | 40. E. Morse          | 52. J. W. Coburn               | 64. Stables                      |
| 5. C. Hartshorne  | 19. Foundry        | 29. W. Lewis       | 41. Stable            | 53. W. Rhodes                  | 65. W. Crowley                   |
| 6. A. Nickerson   | 20. Pattern Shop   | 30. D. E. Everett  | 42. C. Morse          | 54. H. N. Goodbold             | 66. Birds Paper Mill             |
| 7. B. Neal        | 21. Counting House | 31. C. Everett     | 43. Hairs of J. Morse | 55. T. W. Kennedy              | 67. Mrs. Johnson                 |
| 8. C. Hartshorne  | 22. H. Plimpton    | 32. B. Lewis       | 44. Col. T. S. Webb   | 56. W. Fairbanks               | 68. Harness Shop                 |
| 9. J. Marshall    | 23. H. M. Plimpton | 33. Mrs. A. Lewis  | 45. F. W. Bird        | 57. C. Brooks                  | 69. C. Shop                      |
| 10. C. Ellis      | 24. Boarding House | 34. Caburn         | 46. Paper Mill        | 58. L. Jennings                | 70. F. W. Bird                   |
| 11. C. Hartshorne | 25. " "            | 35. Grover         | 47. " "               | 59. L. Gould                   | 71. W. Lewis                     |
|                   |                    | 36. Shop           | 48. " "               |                                | 72. I. Perkins                   |
|                   |                    |                    |                       |                                | 73. F. W. Bird                   |
|                   |                    |                    |                       |                                | 74. E. Palleys (Blacksmith Shop) |
|                   |                    |                    |                       |                                | 75. " "                          |
|                   |                    |                    |                       |                                | 76. F. W. Bird                   |
|                   |                    |                    |                       |                                | 77. J. Cheney                    |

KEY TO BUILDINGS.

N.B. Turnpike later Norfolk St, now Washington St.

Norfolk Co.  
Wall Map  
Day Col.

F. H. Day Collection

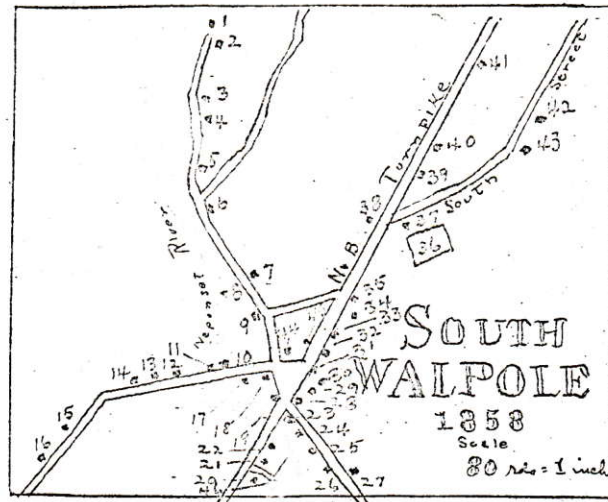

|                  |                |                    |
|------------------|----------------|--------------------|
| 1. W. BACON      | 16. J. CARROLL | 31. BILLINGS S.    |
| 2. W. BOYDEN     | 17. T. CLARK   | 32. J. P. BOYDEN   |
| 3. D. E. SMITH   | 18. JOHN MANN  | 33. B. S. SHOP     |
| 4. SMITH'S MILL  | 19.            | 34. SCHOOL         |
| 5. S. GRAY       | 20.            | 35. T. CLARK P.O.  |
| 6. R. OGDEN      | 21.            | 36. CEMETARY       |
| 7. T. CLARK      | 22.            | 37. N. B. WILMARTH |
| 8. CLARK'S MILL  | 23.            | 38. A. H. BILLINGS |
| 9. T. CLARK      | 24. STORE      | 39. LELAND         |
| 10. CLARK'S MILL | 25. J. BOYDEN  | 40. E. SMITH       |
| 11. SAW MILL     | 26.            | 41. G. WHITE       |
| 12. B. MOWRY     | 27. J. BOYDEN  | 42. H. BOYDEN      |
| 13. C. MOWRY     | 28. MRS FISHER | 43. A. BERRY       |
| 14. S. BOYDEN    | 29. CHURCH     | 44. HOTEL          |
| 15. J. CARSIDE   | 30. STORE      | 45. MRS. BUGGLES   |
|                  |                | 46. GRIST MILL     |

KEY TO BUILDINGS

N.B Turnpike later Norfolk St., now Washington St.

*F. H. Day Collection*



## North Street, Walpole, Mass. -1733

North Street-- "A rhoad laid out by Capt. Morse, Joseph Hartshorn and Thomas Clap, Feb. 25, 1733. Laid out 2 Rods wide from Bubbling Brook between the land of Eleazer Bullard and James Jero so far as their land goes, from thence to the house of Moses Ellis as straight as may be, and from said Jacob's house to Nathaniel Gay's farm, as it is marked out, and from Gay's ~~Woods~~ farm to the house of Jeremiah Day, as straight as may be, and from said Day's to the Wrentham road as straight as may be, between John Hall's and Thomas Hartshorn's. The above said road was proposed and accepted by the town at their anniversary meeting in March 1734"-- from Walpole Town records, copied from Isaac Newton Lewis's "History of Walpole".

note--the Wrentham road is now Main street.

note-2 I believe Mr. Lewis when copying from the town records left out a line, ie: He traces the road down to Moses Ellis's house, but does not continue it on to the Jacob's house, but jumps that stretch of the road, and continues from the Jacob house onto Nathaniel Gay's farm. Who was this Jacob? I have looked through the Walpole Vital Records, (births, marriages and deaths) printed from the town records up to the year 1850, and have found no family by the name of Jacobs, which makes me believe that it the first name of one of the settlers on North street, and not his last name.

note-3 The Woods house on North street is said to have been built in 1814, according to an old resident of that location. It is probably the house of Major John A. Gould. In 1894 I believe Luther Fisher lived in this house. He was a farmer. His brother Nathaniel Fisher lived on the original old Fisher farm on Fisher street. This Fisher house was a small one, I believe two or three houses have been built successively on the site of the original Fisher farm house on Fisher St. The farm was on the left going up Fisher St. from Main St. I have a small sketch of the house made from memory by my father.

I believe a Mr. Turner or Taylor, who was caretaker of Rural Cemetery in 1920 lived in the Woods-Gould house.

note-4 The Goss farm, on North St. The land stretched down as far as High street. In 1851 a Thomas Clap lived there. He was a blacksmith and had a small shop in his yard side of his house. He made door latches, hinges and nails for the houses being built in town in his day. I have an old door latch from this old farm house. Daniel Goos bought the farm. He was born in Germany Oct. 28, 1833 and died on this farm July 25, 1892. His wife had died on Dec. 7, 1868 aged 41 yrs. The neighbors heard the cows lowing and not having seen Mr. Goss for a few days they investigated and found him dead in bed. He had been dead several days. He d. July 25, 1892. Both he and his wife are buried in Maple Grove cemetery. I was told that yet another owner of this farm, while going to work crossing the field or woods

16

opposite his house, dropped dead. His body was found by neighbors later on.

F.R.L.

Frank R. Laramie



17

North Street, North Walpole, Mass.

North street families or farms in 1733.--starting from the old Wrentham Road, which is now Main Street., to Bubbling Brook.

- 1-John Hall
- 2-Thomas Hartshorn-(lived opposite John Hall's farm.)
- 3-Jeremish Day's house
- 4-Nathaniel Gay's farm "as marked out".
- 5-Jacob -----?'s house
- 6-Moses Ellis's house
- 7-James Jero's land
- 8-Eleazer Bullard's land (opposite James Jero's.)
- Bubbling Brook--

This would indicate that there were only 8 farms on North street in 1733. As Nathaniel Gay's farm was described "as marked out" would indicate that it was a new farm and that house and farm buildings had not been built, at the time.

Of the old houses on North street today (1966) perhaps the oldest, which might have been standing in 1733, are the following:

1-Thomas Clap farm--said to have been built in 1712.

- owners--
- 1-Thomas Clap--1851
  - 2-Daniel Goss (Goos) d. 1892
  - 3-Fred Wetherbee
  - 4-Frederick M. Larrabee-1894
  - 5-Mr.----- MacLeese
  - 7-Mr.-----Brown

2-The Dimon Farm--

- owners--A. Fisher jr.?--1851

3-The Healey house (salt-box type house) -very old.

- owners--
- 1-G. Conant?--1851
  - 2-Burke?
  - 3-Healey-1965

Frank R. Larrabee



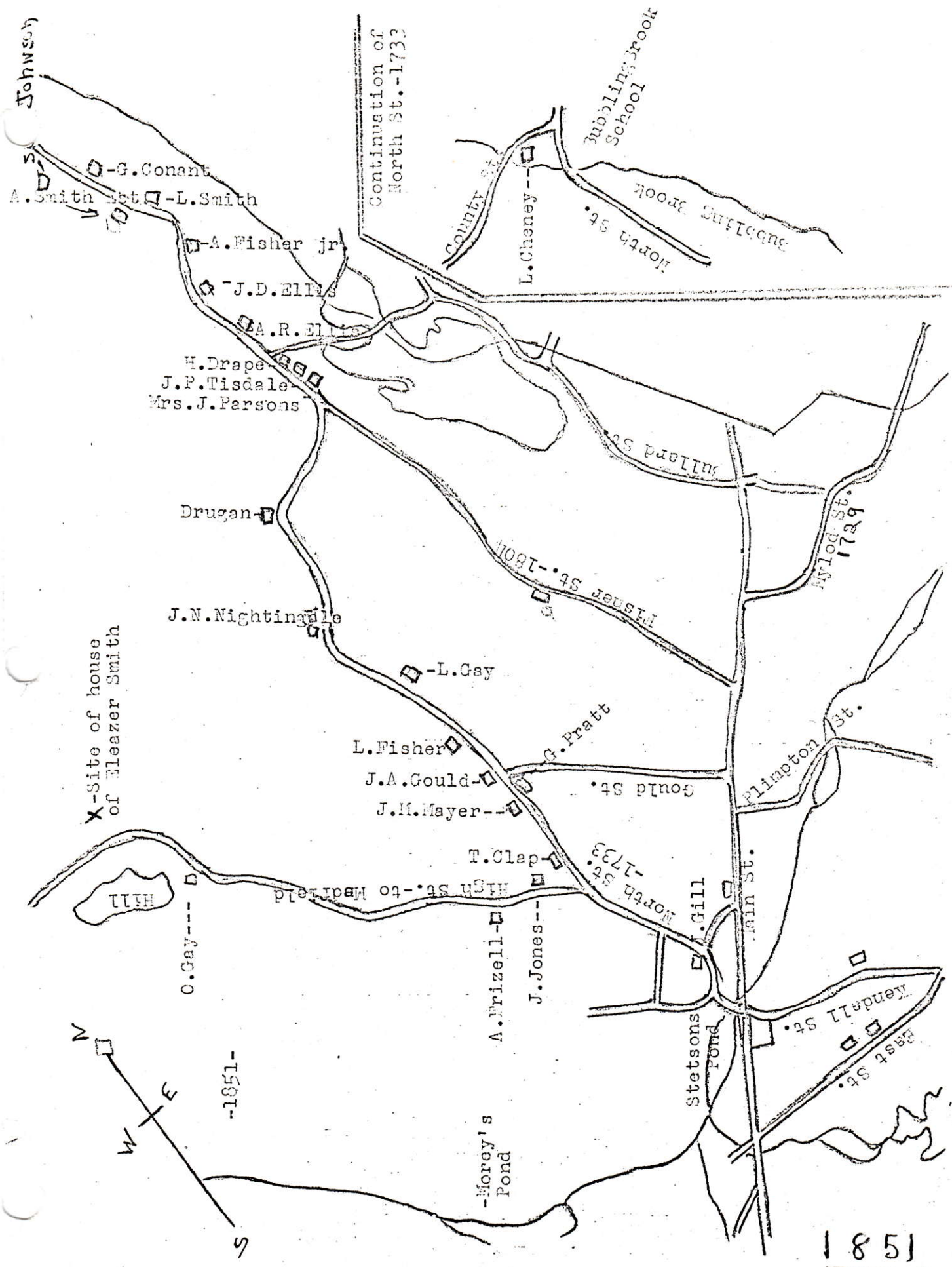

Plan of North Street in 1851--showing houses  
copied by Frank P. Loring

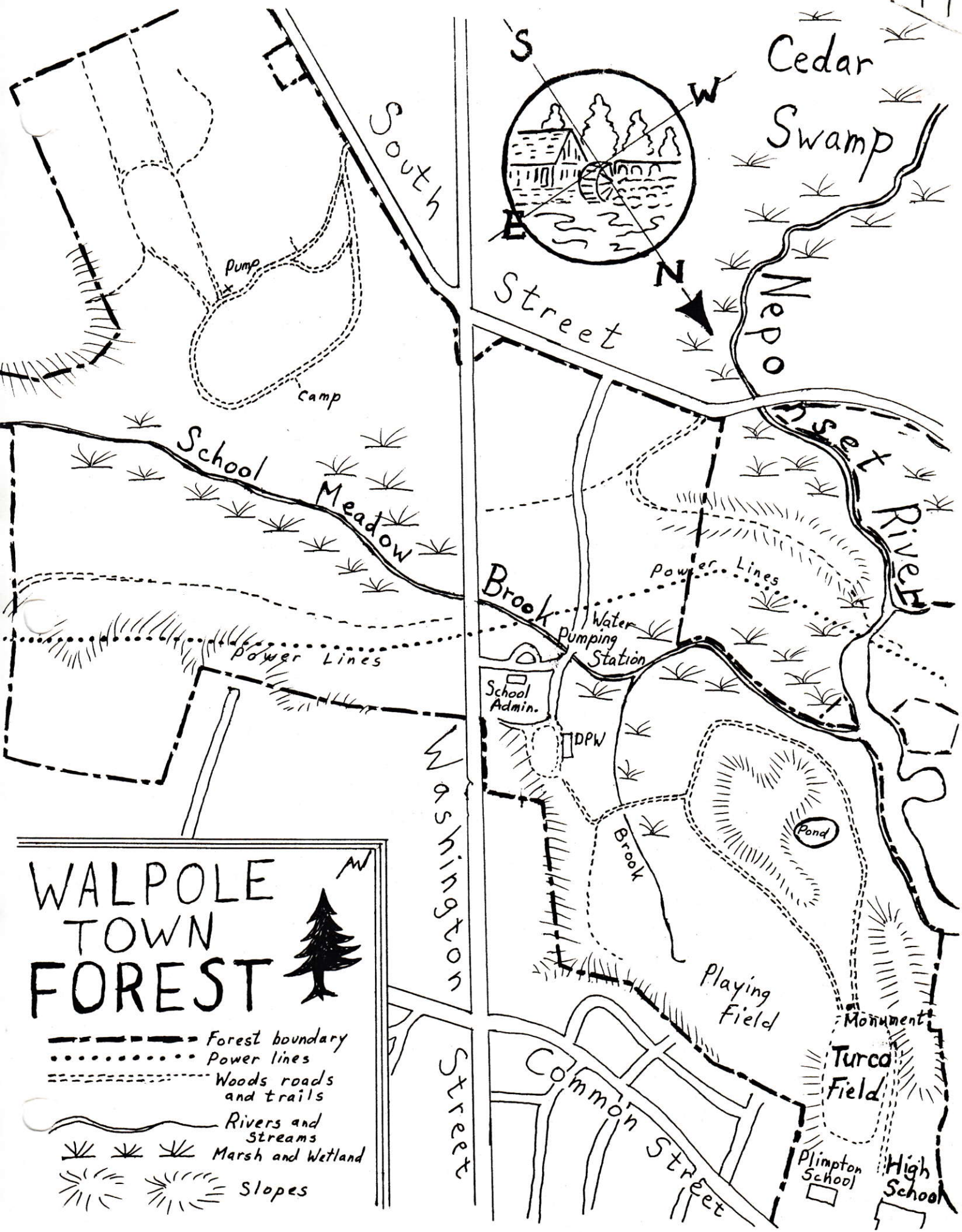

# WALPOLE TOWN FOREST



- Forest boundary
- Power lines
- Woods roads and trails
- Rivers and Streams
- Marsh and Wetland
- Slopes



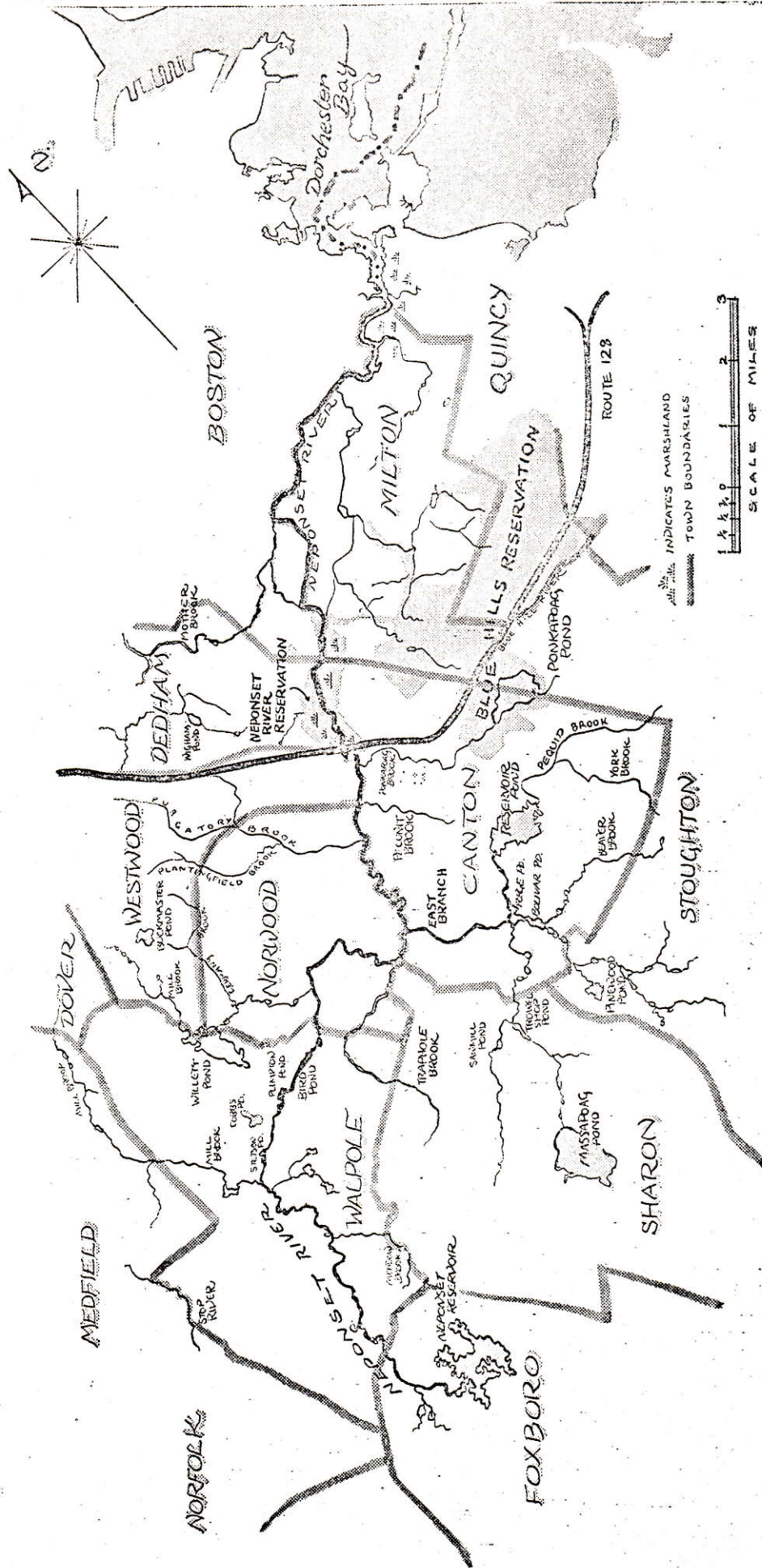

MAP BY L. DRAPER HILL, JR.

Nononset River Watershed area covers a number of towns and was the object of a study recently completed by the state Department of Natural Resources.





Map  
of  
1851

1851

Lanaber collection